



S-Lifting



Chain G8 and
G8 Fittings

CLASSIC G 80





S-Lifting



EQUIPMENT

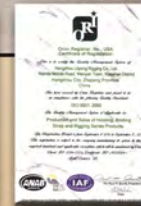



S-Lifting



Quality Control



R&D



Forging Press 4000 Ton capacity



Quench & tempered



Machinery Process By CNC



Chemical Analysis

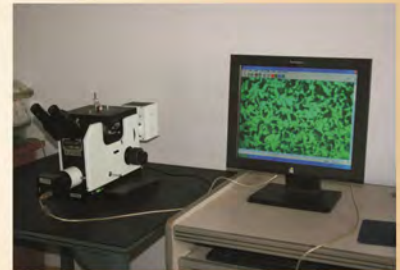

Micrographic Analysis



Fatigue Cycle Test



Magnaflux Crack Detection



Assembly & Packing System



Tensile Test, Capacity 200 tonnes



Tensile Test, Capacity 100 tonnes



Dimension



Marking System

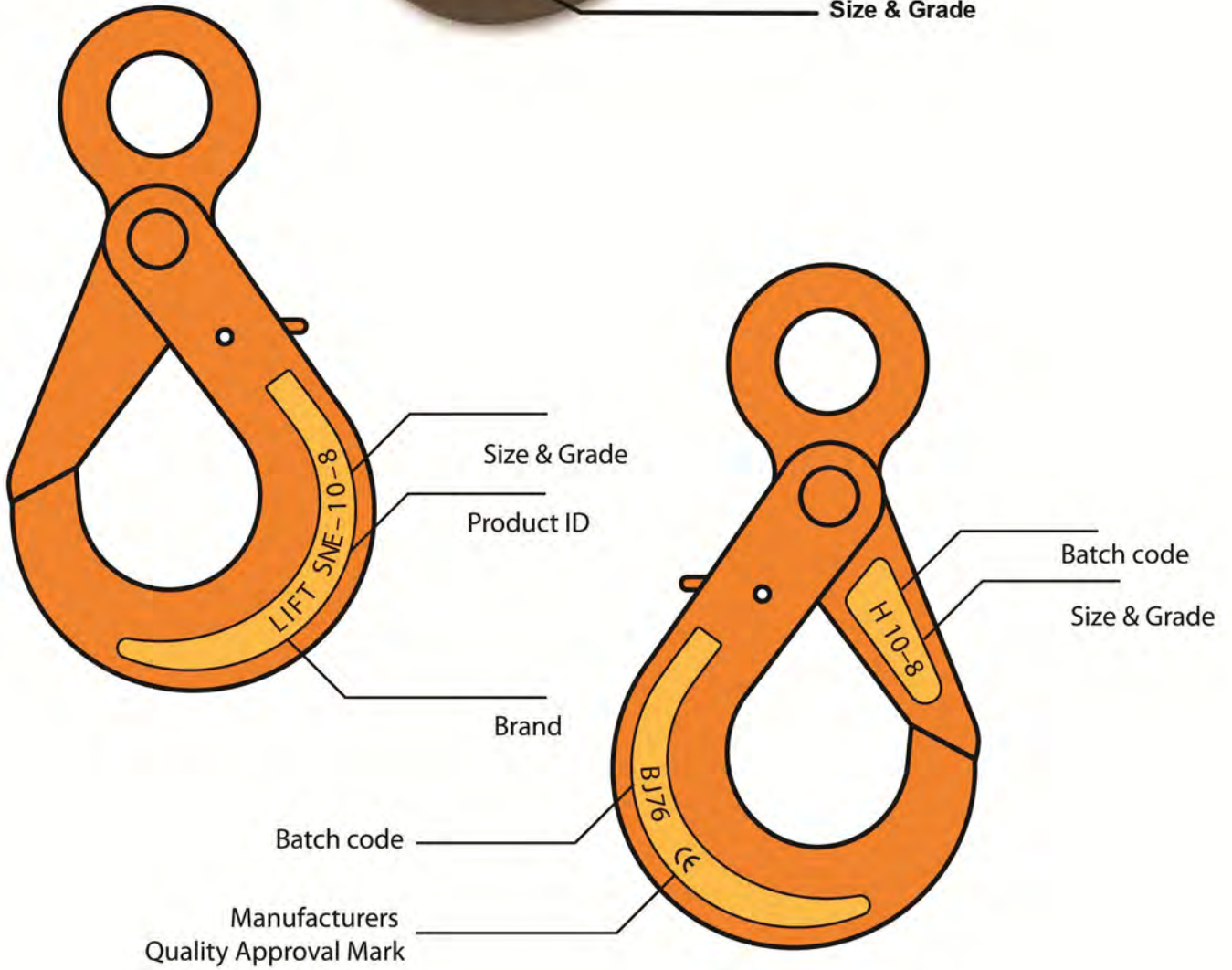
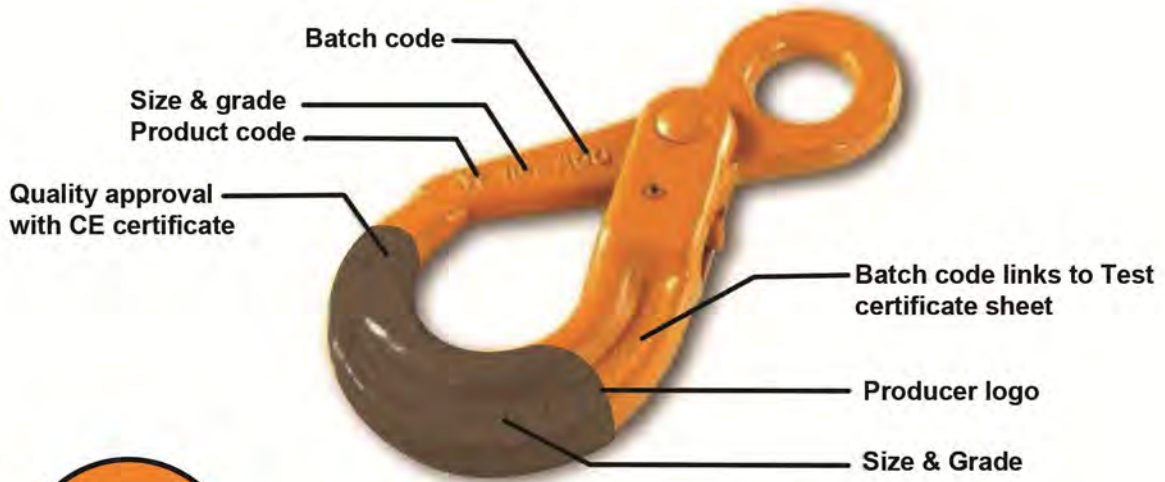

Examples Of Chain Slings 1:4

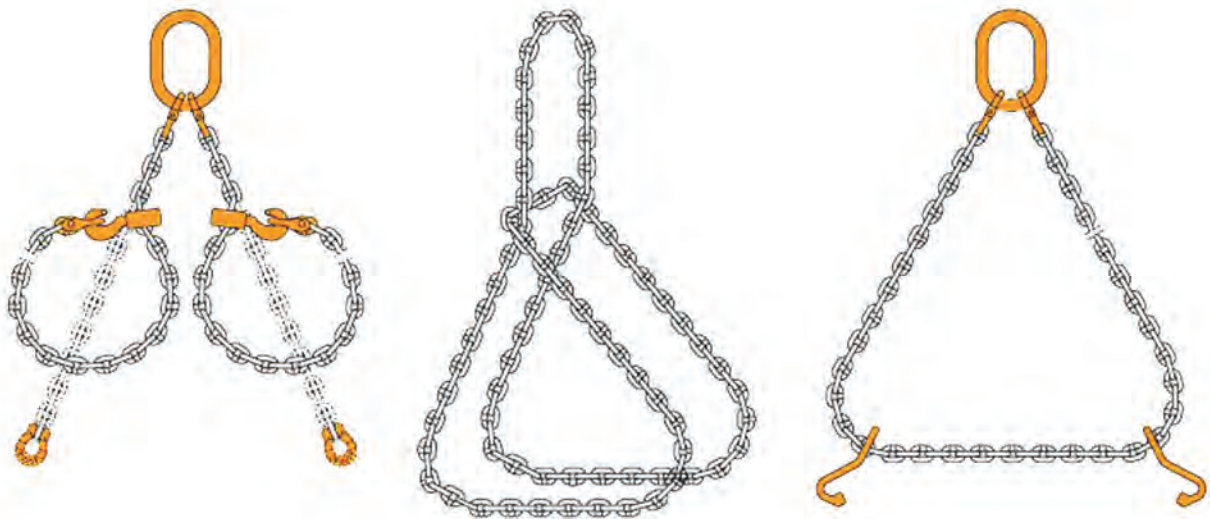

Examples Of Wire Rope Sling & Web Sling 1:5





NEW PRODUCTS RANGE

Model type :BALPV

Available in 1.5,2.5,4,6,7,10 and 16 tonne(working load limit) capacities.

The new SL -Alloy Weld-on Transport Rings are an important addition to SL LIFT range of load securing and restraint equipment as permanent anchor points for lashing or lifting.

Just some of the many applications for this innovative product include mining, offshore exploration, road or rail transport and maritime associated industries.

FEATURES:

Manufactured using ALLOY steel, quenched and tempered.

Offers a full working load limit at all angles.

Extremely high strength attachment as lifting and lashing point.

Forged welding black with SL -Alloy, WWL, month and year of manufacture in raised markings.

Easily welded into required position with the aid of height lugs on the weld block.

Functional compact design.

Lifting ring has durable baked enamel finish.

Safety Factor of 5:1.

Test Certificate available.

Weld instruction details supplied with each unit.

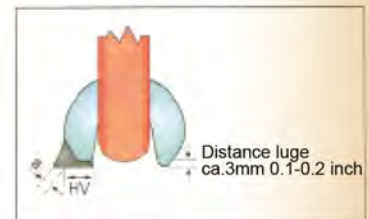
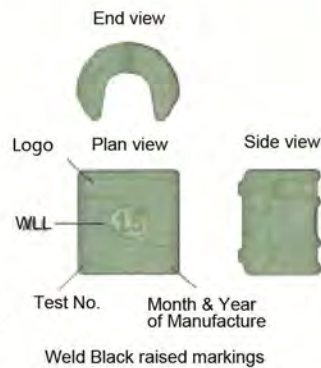
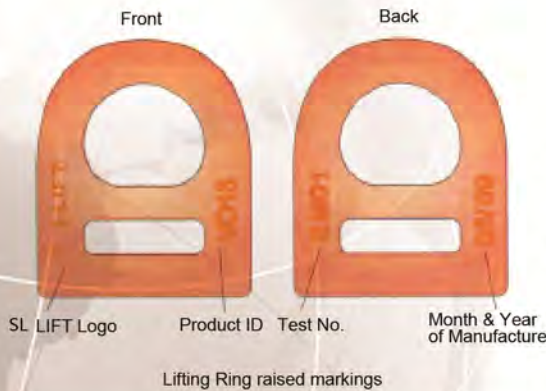

Welding seam attachment example

Item No	WLL	A	B	C	D	E	F	G	I	M	Weld mm	Weight	Weld	Weld
	tonnes	mm	mm	mm	mm	mm	mm	mm	mm	mm	HV+AI	Kg	Length	Volume
SL-BALPV015	1.5	38	79	66	14	13.5	32	25	31	2	HV5+a3	0.40	2x33mm	ca.1.2 cm3
SL-BALPV025	2.5	45	92.5	77	16	13.5	36	27	37	3.5	HV7+a3	0.60	2x40mm	ca.2.6 cm3
SL-BALPV040	4	51	102	87	18	16.5	42	32	40.5	2	HV8+a3	0.90	2x40mm	ca.3.2 cm3
SL-BALPV067	6.7	67	138	115	24	22.5	61	44	55	4	HV12+a4	2.0	2x60mm	ca.8.7 cm3
SL-BALPV100	10	67.5	142	129	26.5	57.5	75	53	57.5	4	HV16+a4	3.0	2x60mm	ca.15.5 cm3
SL-BALPV160	16	100	215	190	40	26	95	69	85	5	HV25+a6	6.9	2x90mm	ca.56 cm3



Bolt-on, Rotating Lifting Lugs Model type: BRLP

Available in 7 capacities from 1 to 10

This new range of Bolt-on Lugs offers the ideal solution for lifting or load lashing when a permanent or semi-permanent point is required.

Product applications include
Road and Rail Transport,
Mining, Offshore Exploration,
Heavy Industry and
Construction.

FEATURES:

- High strength lifting or lashing point.
- Has full working load limit at all angles and rotations.
- Easily attached to the required lifting base or item.
- Lifting lug manufactured from Alloy steel, quenched and tempered.
- All SL -Alloy-V Bolt-On Lugs are 100% magnetically crack inspected (MCI).
- Eye screw in electro galvanised finish.
- Durable powder coated finish on the lifting lug
- Functional compact design.
- Lifting lug with raised markings indicating Month and Year of manufacture, W.L.L. and HH-Alloy-V ID and test number for accurate traceability.
- Eye screw with raised markings showing W.L.L. size of thread and torque required when tightening.
- Test Certificate available.
- Several sizes available with UNC threads.

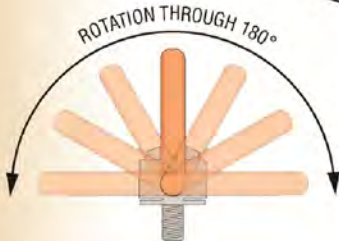
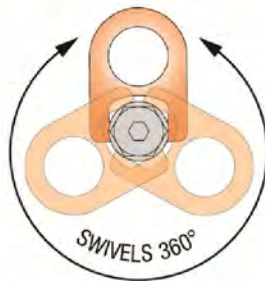

DIMENSIONS

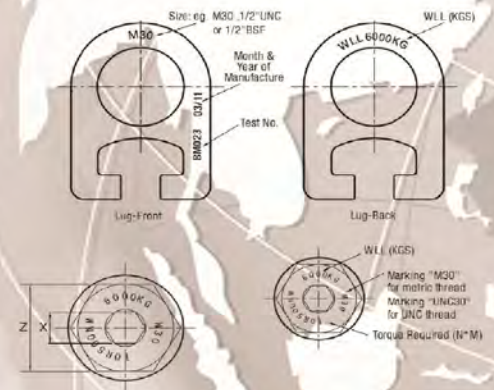
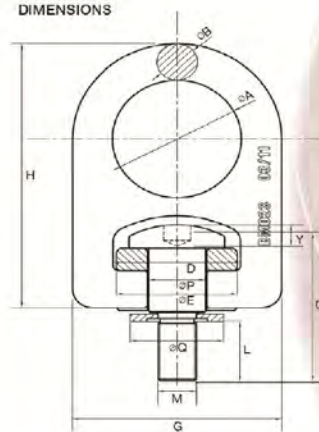

Item No	WLL Tonnes	Tread Size mm	Torque N*M	L	A	B	C	D	E	H	G	P	Q	X	Y	Z	Weight Kg
SL-BRLP-M12	1.0	M12	100	33	35.6	11.2	60	35.3	33.5	80.5	60.5	15.6	31.2	8.03	5	25.4	0.4
SL-BRLP-1/2UNC	1.0	1/2UNC	100	33	35.6	11.2	60	35.3	33.5	80.5	60.5	15.6	31.2	8.03	5	25.4	0.4
SL-BRLP-A16	1.5	M16	150	33	35.6	11.2	60	35.3	33.5	80.5	60.5	15.6	31.2	8.03	5	25.4	0.4
SL-BRLP-M20	2.5	M20	300	33	61	19.1	82.6	60.2	57.2	137	103	26.7	53.3	15.9	9.4	44.5	1.8
SL-BRLP-M24	4	M24	400	37	61	19.1	82.6	60.2	57.2	137	103	26.7	53.5	15.0	9.4	44.5	1.8
SL-BRLP-M30	6	M30	500	50	81.3	25.4	110.8	80.3	76.2	183	137.2	35.6	71.1	22.1	15	60.3	4.1
SL-BRLP-M36	7	M36	800	54	81.3	25.4	110.8	80.3	76.2	183	137.2	35.6	71.1	22.1	15	60.3	4.1
SL-BRLP-M42	10	M42	1000	63	101.6	31.8	139.4	100.3	95.3	229	171.5	44.5	88.9	27.1	18	76.2	9.0
SL-BRLP-1 5/8UNC	10	1 5/8UNC	1000	63	101.6	31.8	139.4	100.3	95.3	229	171.5	44.5	88.9	27.1	18	76.2	9.0



NEW PRODUCTS RANGE

Model type: G80

S-Lifting Grade 80 Chain is designed for Chain slings for industrial lifting applications. It is made from alloy steel, hardened and tempered. It has a high resistance to impact and meets critical requirements of EN818-2 "Short link Chain for lifting purposes".

Size available from 6mm to 32mm

Marked with Chain grade with traceability mark.

Made from G80 alloy steel with safety factor of 4 to 1

Test Certificates available upon request.

Conforms to EN818-2.

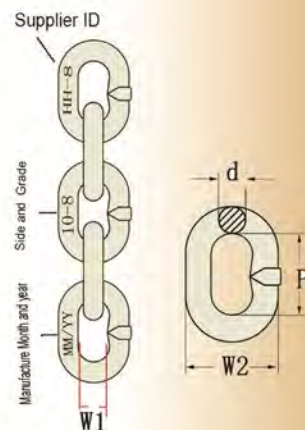

Item No	full from	cut length	SIZE mm	WLL tonne	BL Kn	DIMENSIONS mm			WEIGHT kg per m
						P	W1(min)	W2(max)	
SL-02-06	148006C	6x18	1.12	45.2	18	7.8	22.2	0.8	
SL-02-07	148007C	7x21	1.5	61.6	21	9.1	25.9	1.1	
SL-02-08	148008C	8x24	2	80.4	24	10.4	29.6	1.4	
SL-03-10	148010C	10x30	3.15	126	30	13	37	2.2	
SL-02-13	148013C	13x39	5.3	212	39	16.9	48.1	3.8	
SL-02-16	148016C	16x48	8	322	48	20.8	59.2	5.7	
SL-02-18	148018C	18x54	10	407	54	23.4	66.6	7.3	
SL-02-20	148020C	20x60	12.5	503	60	26	74	9	
SL-02-22	148022C	22x66	15	608	66	28.6	81.4	10.9	
SL-02-26	148026C	26x78	21.2	849	78	33.8	96.2	15.2	
SL-02-32	148032C	32x96	31.5	1290	96	41.6	118	23	

Connect Link (Type CL)

S-Lifting CL Type Connecting Links are commonly used to connect Head Rings, Chain, Hooks and other lifting components for Chain Slings and a wide variety of other uses.

- Marked with Chain size, grade.
- branded with manufacture quality mark.
- Made from G80 alloy steel with a safety factor of 4 to 1.
- Test Certificates available upon request.

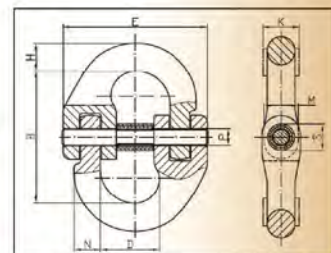

Item No	size (mm)	Dimensions									WLL (t)	MPF KN (t)	BF KN (t)
		B	D	E	H	M	N	K	P(pin)	S			
SLC6	6	45	18	40	7	10.5	7	≤7.7	4.8	8.5	1.1	21.6	43.2
SLC7	7	52	19	47	8.3	12.3	8	≤9	6	10.5	1.5	29.4	58.9
SLC8	8	65	23	55	9.5	13.5	9	≤10.3	6.3	11	2	39.2	78.5
SLC10	10	73	27	63	12	17.2	11.5	≤12.9	8	12.5	3.2	62.8	126
SLC13	13	88	34	82	16	22.7	15.5	≤16.8	10	15.5	5.3	104	208
SLC16	16	103	39	105	19	28	19	≤20.6	14	21.5	8	157	314
SLC20	20	116	48	122	23.5	34.8	24	≤25.8	16.1	23.5	12.5	245	491
SLC22	22	133	55	135	26.5	35.5	26.5	≤28.3	17	26	15	294	589
SLC26	26	148	66	163	31.5	42	29.5	≤33.4	19.5	28.5	21.2	416	832
SLC32	32	183	79	206	38	51	38	≤40.8	25	34	31.5	618	1236



Master Link (Type SD)

S-Lifting SD Type Head-Rings are designed to cater for single leg and double leg Chain Slings or Wire Rope Sling applications.

Marked with single and double Chain sizes, product ID, grade with manufacture quality mark and SL LIFT BRANDED branded. Manufactured from G80 alloy steel, safety factor 4 to 1 for Chain Sling, 5 to 1 for Wire Rope Sling.

Test certificates available upon request.

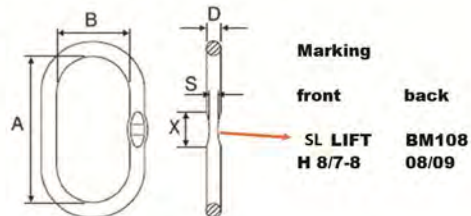

Item No	Marking	Nominal		Dimensions				Weight	Test No	WLL (Kgs)	PROOF LOAD(KN)	MBL (KN)
		size	mm	mm								
		Single	Double	D	A	B	SxX	Kgs				
SL-883507A	B7/6-8	7	6	14	110	70	7*25	0.34	BM107	1900	37.28	74.56
SL-883508A	B8/7-8	8	7	14	120	70	7*25	0.44	BM108	2600	51.01	102.02
SL-883510A	B10/8-8	10	8	16	140	80	7*25	0.66	BM110	3500	68.67	137.34
SL-883513A	B13/10-8	13	10	20	160	95	11*35	1.20	BM113	5500	107.91	215.82
SL-883516A	B16/13-8	16	13	27	190	110	13*45	2.53	BM116	9200	180.50	361.01
SL-883520A	B20/16-8	20	16	32	230	130	16*45	4.70	118.00	13800	270.76	541.51
SL-883522A	B22/20-8	22	20	38	275	150		7.50	BM122	21600	423.79	847.58
SL-883526A	B26/22-8	26	22	45	340	180		12.80	BM126	26000	510.12	1020.24
SL-883532A	B32/26-8	32	26	50	350	190		17.20	BM132	36700	720.05	1440.11
SL-883536A	B36/32-8	36	32	56	400	200		24.20	BM136	54500	1069.29	2138.58

Clevis Style Master Links

·Used for Single Leg Chain Slings eliminating the use of a Connector to a Master Link, ensuring correct dimension.

·Forged Alloy Steel

·Quenched & Tempered

·Proof Load is 2 times of the Working load Limit

·Ultimate load is 4 times of the working load limit

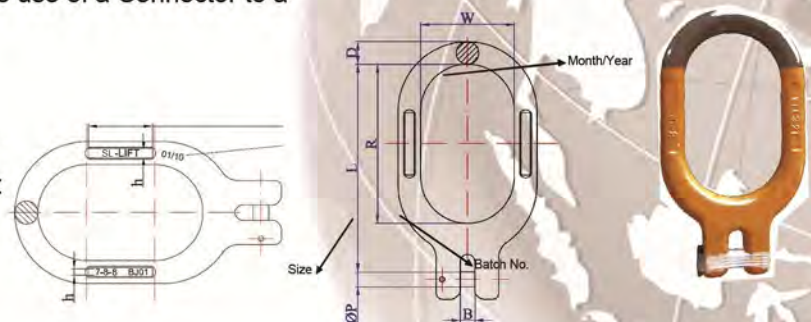

Item No	Chain Size	Weight (kgs)	W.L.L. (kgs)	Dimensions in (mm)						Marking		
				B	D	L	P	R	W	side A	side B	h
SL-CS7-8-8	7-8-8	0.7	2000	9	16	138	9.7	105	60	HH-LILFT 01/10	7-8-8 BJ01	4.5
SL-CS10-8	10-8	1.2	3200	12	18	167	12	128	75	HH-LILFT 01/10	10-8 BJ02	5
SL-CS13-8	13-8	2.3	5300	15	22	203	16	150	90	HH-LILFT 01/10	13-8 BJ03	5
SL-CS16-8	16-8	3.8	8000	18	26	230	20	165	100	HH-LILFT 01/10	16-8 BJ04	6

Master Link Multi (Type MD)

Master Link Multi (Type MD)

S-Lifting MD Type Head-Rings are designed to cater for single leg and double leg Chain Slings or Wire Rope Sling applications.

- Marked with single and double Chain sizes, product ID, grade with manufacture quality mark and SL LIFT branded.
- Manufactured from G80 alloy steel, safety factor 4 to 1 for Chain Sling, 5 to 1 for Wire Rope Sling.
- Test Certificates available upon request.

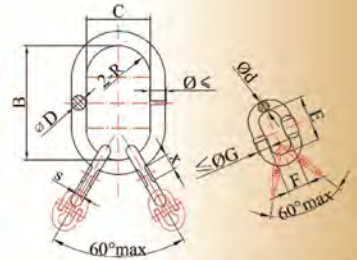

Item No	SIZE	B	C	D	E	F	d	G	S	X	Weight	WLL	
	mm												kg
SL- MC8	6,7,8	180	90	19	21	88	44	15	17	8	25	1.9	3.5
SL- MC10	10	240	120	25	27	114	57	20	23	13	35	4.4	5.5
SL- MC13	13	280	140	30	33	130	63	25	28	17	48	7.7	9.4
SL- MC16	16	300	150	35	40	160	80	30	33	17	48	12.3	13.8
SL- MC20	20	330	165	42	46	180	90	35	39	25	56	19.5	21.6
SL- MC22	22	360	180	48	55	200	100	40	45	25	56	28	26.8
SL- MC26	26	400	250	70	75	300	150	50	56	32	60	70	37.4
SL- MC32	32	400	250	80	86	300	170	60	67	38	60	95	56.8

OL Type Omega Link

S-Lifting OL Type Omega Links are commonly used in conjunction with recessed Head Rings and Chain for Chain Slings. They are also a Marked with Chain size, grade and SL LIFT branded with manufacture quality mark.

- Made from G80 alloy steel with a safety factor of 4 to 1.
- Test Certificates available upon request.

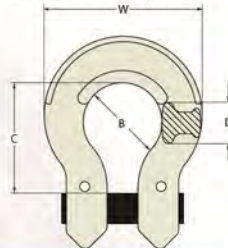

Item No	WLL	Wt.	DIMENSIONS		
	tonne	kg	B	C	W
SL-60-1.12	1.12	0.12	20.5	25	41
SL-60-2.00	2	0.22	23.5	35	52
SL-60-3.15	3.15	0.36	31.5	40.5	62
SL-60-5.30	5.3	0.71	41	54	81
SL-60-8.00	8	1.3	49.5	64	99

CC Type Clevis Claw Hooks

S-Lifting CC Type Clevis Claw Hooks have the advantage of shortening a Chain Sling without loss of the working load limit of the sling. The Clevis allows easy connection to Chain. Not recommended for use as a bottom fitting of sling for back-hooking and reeving applications.

- Marked with Chain size, product ID, grade with manufacture quality mark and SL LIFT branded.
- Manufactured from G80 alloy steel with a safety factor of 4 to 1.
- Test Certificates available upon request.

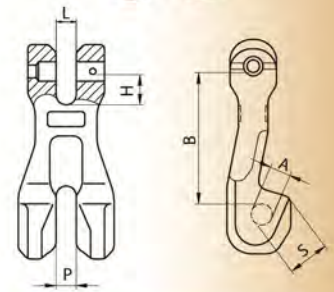

Item No	CHAIN	WLL	Wt.	DIMENSIONS					
	SIZE	tonne	kg	A	B	P	L	H	S
SL-61-06	6	1.1	0.17	8	44	7.5	7.5	10.3	12
SL-61-07	7,8	2	0.41	10.5	61.7	9.5	9.5	14	17
SL-61-10	10	3.2	0.97	12.4	92	13	13	18.4	28
SL-61-13	13	5.3	2	16	115	16.5	16.5	22.7	34.5
SL-61-16	16	8	3.32	19.5	143	21	21	28.5	40
SL-61-18	18,20	12.5	6.2	23	152	23.5	23.5	33.6	46
SL-61-22	22	15	8.5	26	195	25.5	25.5	39	57.5



Grab Hook Eye (GE)

S-Lifting GE Type Eye grab hook provides the flexibility to shorten Chain Sling and can be used for back-hooking. S-Lifting Grab Hooks come with supporting lugs to allow no reduction of the working load limit. The eye is designed for easy connection of Chain Connector.

- Marked with Chain size, product ID, grade with manufacture quality mark and SL LIFT branded
- Made from G80 alloy steel with safety factor of 4 to 1
- Test Certificates available upon request.

Item No	SIZE	WLL	Wt.	DIMENSIONS				
				A	B	C	D	W
	mm	tonne	kg	mm	mm	mm	mm	mm
SL -62-06	6	1.12	0.25	76.5	8	8	13	45
SL -62-08	7, 8	2	0.4	106	11	9.5	16	63
SL -62-10	10	3.15	0.6	126	13	12	20	79
SL -62-13	13	5.3	1.2	156	16	15	25	100
SL -62-16	16	8	2.7	193	20	19	28.5	122
SL -62-20	18, 20	12.5	4.3	226	25	20	36	150.5
SL -62-22	22	15	6.4	269	26	27	42	169
SL -62-26	26	21.2	9.8	298	30	32	45	175
SL -62-32	32	31.5	19.4	361	38	38	57	189

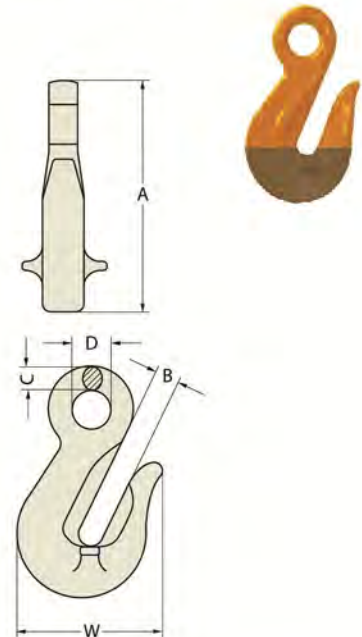

Grab Hook Clevis (GC)

S-Lifting GC Type Clevis grab hook provides the flexibility to shorten Chain Slings and can be used for back-hooking. SL LIFT Grab Hooks come with supporting lugs to allow no reduction of the working load limit. The Clevis is designed for easy connection of Chain.

- Marked with Chain size, product ID, grade with manufacture quality mark and SL LIFT branded.
- Made from G80 alloy steel with safety factor of 4 to 1
- Test Certificates available upon request.

Item No	SIZE	WLL	Wt.	DIMENSIONS				
				A	B	C	D	W
	mm	tonne	kg	mm	mm	mm	mm	mm
SL -63-06	6	1.1	0.28	76	7.6	34.5	7.5	46
SL -63-08	7, 8	1.5	0.3	89	10.4	40	9.5	51
SL -63-10	10	3.2	0.95	125.8	13	48	13	72.7
SL -63-13	13	5.3	1.97	154	16	59	16.5	90
SL -63-16	16	8	3.45	179.2	19	68	19	109
SL -63-20	18, 20	12.5	5.3	243	23	80	23	130
SL -63-22	22	15	7.8	280	26	98	25.5	151
SL -63-26	26	21.2	14.5	309	30	110	30	175



Sling Hook Eye Type (SE) With Forged Steel Latch

S-Lifting SE Type Eye Sling Hooks are a general purpose hook suitable for most slinging applications. They come with heavy duty latch for added safety. Eye allows easy connection to coup links and can be attached to lifting apparatus.

- Marked with Chain size, product ID, grade with manufacture quality mark and SL LIFT branded.
- Manufactured from G80 alloy steel with a safety factor of 4 to 1.
- Test Certificates available upon request.



Item No	Chain	Pcs/pack	Dimension mm								Weight/pcs.	W.L.L.
	mm		D	E	F	G	H	O	O1	R	Approx	max
												kg
SL-64-06	6	10	18	10	20	16,5	21	25	19	84,5	0,33	1,12
SL-64-07	7 - 8	20	24	11	25	19	27	32	25	106	0,56	2
SL-61-10	10	20	30	16	34	26	33	40	31	131	1,2	3,15
SL-64-13	13	10	38	19	43	33	42	48	39	164	2,35	5,3
SL-64-16	16	4	44	25	50	40	50	55	45	182,5	3,72	8
SL-64-20	20	1	53	27	55	48	54	61	54	205	5,95	12,5
SL-64-22	22	1	60	30	60	50	61	71	61	225	7,87	15

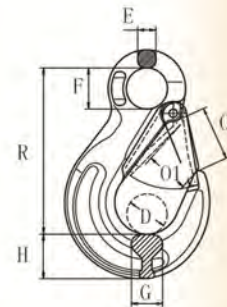

Sling Hook Clevis Type (SC) With Forged Steel Latch

S-Lifting SC Type Clevis Sling Hooks are a general purpose hook suitable for most slinging applications. They come with forged latch for added safety. Clevis allows easy connection to Chain.

- Marked with Chain size, product ID, grade with manufacture quality mark and SL LIFT branded.
- Manufactured from G80 alloy steel with a safety factor of 4 to 1.
- Test Certificates available upon request.



Item No	Chain	Pcs/pack	Dimension mm								Weight/pcs.	W.L.L.
	mm		A	D	G	H	O	O1	R	PxL	Approx	max
												kg
SL-65-06	6	10	7	18	16,5	20	25	19	69	7,4x16,5	0,27	1,12
SL-65-07	7 - 8	20	9	25	19	28	32	26	94,5	9,6x23	0,61	2
SL-65-10	10	20	11,5	30	25	33	39	31	109	12,5x29,5	1,12	3,15
SL-65-13	13	10	14,5	38	30	40	48	39	135	16x37	2	5,3
SL-65-16	16	4	17,5	44	37	47	55	45	155	20x52	3,4	8
SL-65-20	20	1	23	52	51	52	61	53	183	24x73	6,8	12,5
SL-65-22	22	1	24,5	60	50	62	71	61	212	27x71	9	15

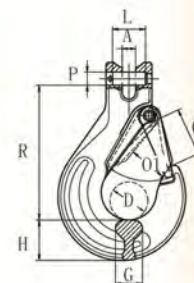

Self Locking Hook, Eye Type (LE)

S-Lifting LE Type Eye Self-Locking Hook allows the hook to remain open until the load is engaged. The hook will not open until the trigger at the back is pressed. The eye style allows easy connection to Chain Connectors, Shackles and Wire Rope Slings.

- Marked with Chain size, product ID, grade with manufacture quality mark and SL LIFT branded.
- Manufactured from G80 alloy steel with a safety factor of 4 to 1.
- Test Certificates available upon request.
- Spare Trigger Kits are available.



Item No	CHAIN		DIMENSIONS						
	SIZE	WLL	Wt.	A	B	D	R	H	M
	mm	tonne	kg	mm	mm	mm	mm	mm	mm
SL -66-06	6	1.1	0.5	22	34	10.5	110.5	20	15
SL -66-07	7,8	2	0.8	25	46	12	136	24	20
SL -66-10	10	3.15	1.5	32	58	13	169	28	26
SL -66-13	13	5.3	2.8	40	69	16.5	208	40.5	32.5
SL -66-16	16	8	5.4	50	86	20	254.5	50.5	41
SL -66-20	18, 20	12.5	10	61	92	26.5	290	62	50
SL -66-22	22	15	13.4	72	98	30	320	65	52
SL -66-26	26	21.2	18.5	80	110	34.3	362	75	60
SL -66-32	32	31.5	44.5	105	166	45	472	97	79.5

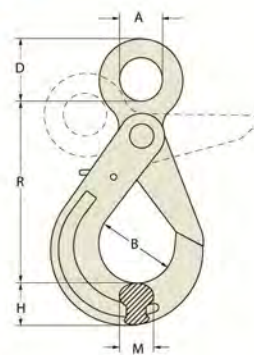

Self Locking Hook, Clevis Type (LC)

S-Lifting LC Type Clevis Self-Locking Hook allows the hook to remain open until the load is engaged. The hook will not open until the trigger at the back is pressed.

The clevis style allows easy connection to the Chain.

- Marked with Chain size, product ID, grade with manufacture quality mark and SL LIFT branded.
- Manufactured from G80 alloy steel with a safety factor of 4 to 1.
- Test Certificates available upon request.
- Spare Trigger Kits and Load Pins are available.

Item No	CHAIN		DIMENSIONS					
	SIZE	WLL	Wt.	B	C	D	E	W
	mm	tonne	kg	mm	mm	mm	mm	mm
102206	6	1.1	0.4	34	96	32	28	69
102208	7,8	2	0.7	46	118.5	36	36	88
102210	10	3.15	1.5	58	144	46	45	107
102213	13	5.3	2.7	69	181.5	59	50	138
102216	16	8	5.6	86	216	70	60	182
102220	18, 20	12.5	10.5	92	238	81	72	204
102222	22	15	13.8	98	276	98	78	205
102226	26	21.2	18.2	110	311	118	106	240

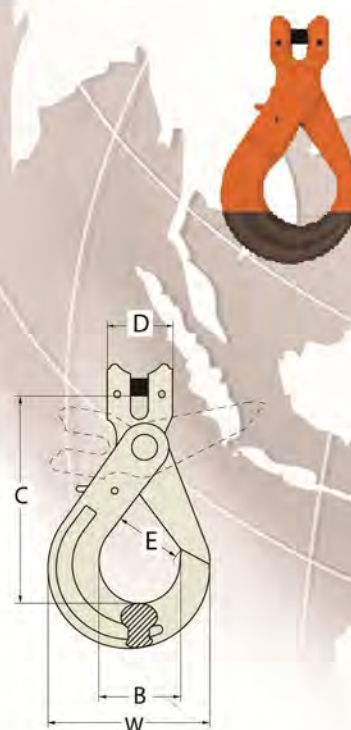

Foundry Hook Eye Type (FE)

S-Lifting FE Type Clevis Foundry Hooks are a special purpose hook with large mouth opening, The clevis allows easy connection to the chain. Suitable for lifting pipes and foundry applications.

- Marked with Chain size, product ID, grade with manufacture quality mark and branded.
- Manufactured from G80 alloy steel with a safety factor of 4 to 1.
- Test Certificates available upon request.



Item No	SIZE	WLL	A	D	P	K	H	T	N.W.
	mm	T	mm						
SL-67-7/8	7/8-8	2	18	12	63.5	120	31	25	1.09
SL-67-10	10-8	3.15	22	16	76	146	33	32	1.95
SL-67-13	13-8	5.3	27	19	89	175	44.5	38	3.22
SL-67-16	16-8	8	32	20	101	205	51.5	46	5.26
SL-67-20	20-8	12.5	38	25	114	235	65	56	9.07
SL-67-22	22-8	15	45	29	127	264	68.5	57	11.79

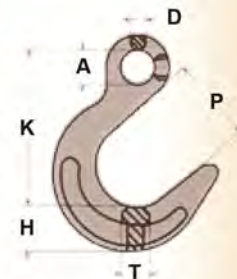

Universal Weld on Hook (WH) with Latch

S-Lifting WH type Weld-on Hooks are a versatile hook for lifting and spreader beam attachment applications, can also be used for any fixed anchor point after welding the hook on.

- Marked with work load limit, grade and SL LIFT branded with manufacture quality mark.
- Made from G80 alloy steel with safety factor of 4:1
- Conforms to AS3776, Test Certificates available upon request.
- Welding instructions supplied with each unit



Item No	CHAIN SIZE	WLL	B.L	Wt.	DIMENSIONS		
	mm	tonne	tonne	kg	B mm	E mm	L mm
SL-68-06	6	1.1	5.5	0.35	53	18	87
SL-68-07	7, 8	2	10	0.55	63.5	26	112
SL-68-10	10	3.2	16	0.87	75	30	127.5
SL-68-13	13	5.3	26.5	1.75	92.5	35	160
SL-68-16	16	8	40	3.0	106	40	180
SL-68-22	22	12.5	62.5	6.16	140	51	236

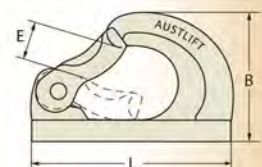

Self Locking Hook, Swivel Type (LS)

S-Lift LS Type Swivel Self-Locking hook have a ball bearing swivel to allow the hook to swivel under load thus reducing the twist of a sling. Designed with enlarged eye for passing larger Shackles without disassemble of the hook.

- Marked with Chain size, product ID, grade with manufacture quality mark and Austlift branded.
- Ball bearing swivel allows the hook to rotate under full load.
- Manufactured from G80 alloy steel with a safety factor of 4 to 1.
- Test Certificates available upon request.
- Conforms to AS3776.
- Spare Trigger Kits and Swivel Bow head are available.

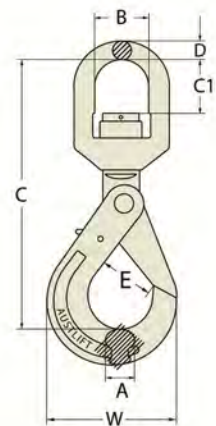

Item No	CHAIN			DIMENSIONS						
	SIZE mm	WLL tonne	Wt. kg	A mm	B mm	C mm	C1 mm	D mm	E mm	W mm
SL-69-06	6	1.1	0.71	15	32.5	164.5	35	11.5	28	69.7
SL-69-08	8	2	1.12	20	36	204	42	13	36.5	88
SL-69-10	10	3.15	2	26	42	240.5	50	15.5	45	107.7
SL-69-13	13	5.3	4	32.5	50	284.5	60	17	53.6	137
SL-69-16	16	8	7.3	38	61	350.5	65	21.5	61	165.5

Swivel Hook with Safety catch(SS)

S-Lift SS Type Swivel Sling Hooks are designed with a plain bush bearing swivel thus allowing the hook to swivel under load. Comes with heavy duty Safety Latch.

- Marked with Chain size, product ID, grade with manufacture quality mark and Austlift branded.
- Manufactured from G80 alloy steel with a safety factor of 4 to 1.
- Test Certificates available upon request.
- Conforms to AS3776.
- Spare Latch Kits are available.



Item No	CHAIN			DIMENSIONS					
	SIZE mm	WLL tonne	Wt. kg	A mm	B mm	C mm	E mm	H mm	L mm
SL-70-08	8	2	0.85	36	88.5	26	27	23.5	190
SL-70-10	10	3.15	1.54	42	104.5	34	32	29.5	233
SL-70-13	13	5.3	3.04	49	135	41	40	38	291.5
SL-70-16	16	8	5.36	61	161	53	45	45.4	352

G80 FITTINGS

Hoisting Hook - Alloy

Sun Smile Lifting Eye Hoist Hooks with Safety Latch are commonly used for general lifting applications such as Wire Rope Slings or Winch Cables.

- Manufactured from forged alloy steel quenched and tempered.
- Capacities available from 1 ton to 11 ton.
- Marked with work load limit and alloy.
- Latch kits are available as spare part.
- Test Certificates available upon request



Item No	DIMENSIONS							
	WLL tonne	B.L tonne	Wt. kg	C mm	C1 mm	D mm	D1 mm	E mm
SL -71-1.0	1	5	0.28	82	110	16	19	22
SL -71-1.5	1.5	7.5	0.4	93.5	125	17.5	23	23
SL -71-2.0	2	10	0.65	103	140.5	21	28	24
SL -71-3.0	3	15	0.94	119	162	23	31	27.5
SL -71-4.5	4.5	25	1.95	146	201	30	39	33
SL -71-7.0	7	35	3.77	186.5	256	38	51	40
SL -71-11	11	55	6.80	231.5	317	46	62	51

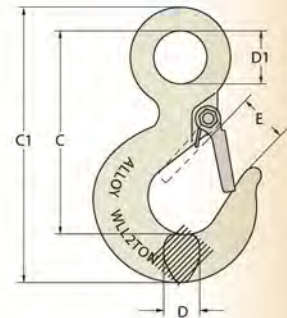

Hoist Swivel Hook - Alloy

Sun Smile Lifting Swivel Eye Hoist Hooks with Safety Latch are commonly used for general lifting and can also be towing applications.

- Manufactured from forged alloy steel quenched and tempered.
- Capacities available from 1 ton to 11 ton.
- Marked with work load limit and alloy.
- Latch kits are available as spare part.
- Test Certificates available upon request

Special Note: This hook is a positioning device & is not intended to rotate under load. Use in salt water requires the shank & nut to be inspected regularly.



Item No	DIMENSIONS								
	WLL tonne	Wt. kg	B mm	C mm	C1 mm	C2 mm	D mm	D1 mm	E mm
SL -72-1.0	1	0.34	32	108	22.5	136	16	9	17
SL -72-1.5	1.5	0.57	37.5	133.5	29.5	163.5	16	12	22.5
SL -72-2.0	2	1.02	42.5	150.5	33	192	17.5	15.8	26
SL -72-2.0	3	1.24	42.5	163	33	209	23	15.8	26
SL -72-4.5	4.5	2.25	48	191	39	246	31	18	32.5
SL -72-4.5	7	4.66	64	243.5	53	313	34	25	43
SL -72-11	11	7.4	70	277	53	364	41.5	28.5	49.5

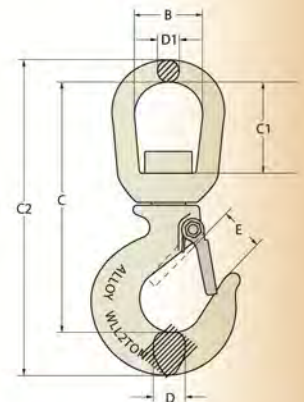



LIFTING SHACKLES

General

Shackles are used in lifting static systems as detachable connecting links for Chain, lifting devices, Wire Rope and other fittings.

Shackle Types

The most common types of Shackle is Dee and Bow encountered in the general lifting industries. Most common Shackle Pins come in Safety Pin and Screw Pin although there are other types of pin configurations available. For non-permanent applications Screw Pin Shackles are generally used where as a Safety Pin Shackle is recommended for long-term uses where the pin of the Safety Shackle may rotate during loading.

Care & Use

1. ensure that the pin is firmly screwed into the Shackle eye and that the pin collar is fully seated onto the Shackle eye.
2. Check that the pin is of the correct length so that the thread is fully engaged in the screwed eye and allows the collar of the pin to be fully seated on the surface of the Shackle eye.
3. If you find that the Shackle pin does not seat properly, this is an indication that the pin may be bent, the mating thread is incorrect or the pin holes are not aligned correctly.
4. The original Shackle pin is specially designed for the WLL of the Shackle, therefore, never replace it with a bolt as the bolt may not be suited to the WLL of the Shackle.
5. With a Safety Pin Shackle never use it unless the nut is fully secured and split pin in place.
6. Make sure the correct Shackle is selected for the intended use and application. Never allow a Shackle to be loaded along its centre line. Shackles should never be loaded in a manner that will cause bending of the body.
7. Ensure the load is on the centre of the pin this can be achieved by placing loose spacers on either side of the Shackle pin or use a smaller jaw width Shackle of a similar load rated capacity.

8. Make sure the correct calculations are used to ensure the correct load capacity for angular loading of the Shackle.

9. High temperatures affect the WLL of the Shackle therefore the working load limit should be reduced by

- 10% for temperatures between 200 & 300°C,
 - 25% for temperatures between 300 & 400°C
- Shackles should never be used at all for temperatures above 400°C.

10. Never attempt to weld or apply heat to Shackles



NOTE:

In accordance with US Federal specification RR-C-271.
Australian AS2741:2002.

SHACKLES

SHACKLE INSPECTION BEFORE USE

Shackles in use should be subject to periodic thorough examination by a competent person. The period between each examination will depend upon amount of use

Maximum wear allowance must not exceed 10% of the original Shackle dimensions.

Ensure the correct type of pin is used and is fully engaged into the

Ensure all markings are legible & clear to read

Make sure the threads are in good order on both pin and body for Screw Pin. For Safety Pin ensure that nut and split pin are in good condition.

Ensure the Shackle is free from corrosion, cracks, nicks, gouges, distortion and excessive wear

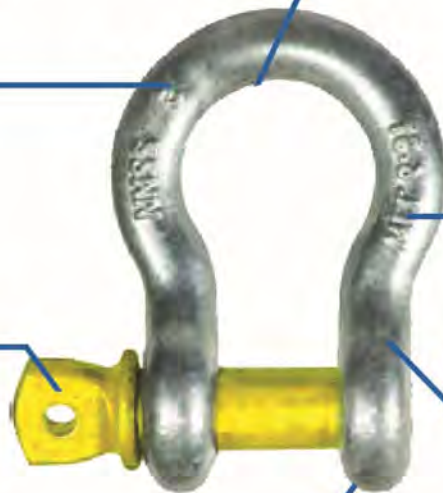

Grade

Supplier I.D.

Alpha-numeric codes give quick reference back to the test certificate.

See reference table # 1~#4

Individually Stramped with the W.L.L. Showing the working load Limit in tonnes.



Alloy Steel Bow Shackles

S-Lifting High-tensile shackles with yellow pin have been developed in accordance with as2741, American standard RR-C-271 Standard.

All S-Lifting's High-tensile shackles are easily identified and traceable in accordance with S-Lifting's quality assurance

system, the following identification marks are embossed on the shackle:

1. Individually stamped with working load limit in tonnes (i.e. W.L.L.)
2. The grade appears in the top of the shackles.
3. An alpha-numeric number prefixed with a "BJ number" can be traced back to the test certificate

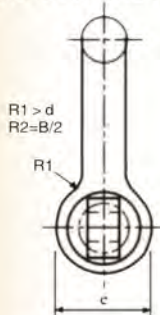

SKETCH 4-1(1)



PICTURE 4-1



PICTURE 4-2

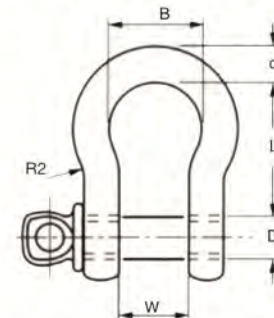

SKETCH 4-2(1)

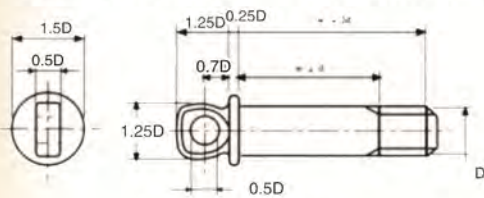

SKETCH 4-1(2)

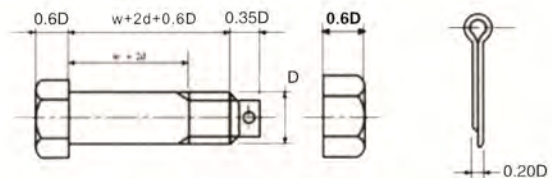

SKETCH 4-2(2)

Bow Screw Pin	Nominal	Dia.	Dia.	Insid	Insid	Insid	Dia	Work	Bow Safety	
Anchor	Shackle	Size	Body	e	e	e	Bos	Load	Anchor	
Item No		Dia	d	Width	Wid	Len	s	Limit	Shackle	
		mm	mm	W	h	gth	e	W.L.L	Item No	
				mm	mm	mm	mm	Tonne		
242305		5	5	6	10	15	22	14	0.33	NA
242306		6	6	8	12	20	29	17	0.5	NA
242308		8	8	10	13	21	31	21	0.75	NA
242310		10	10	11	17	26	37	25	1	NA
242311		11	11	13	18	29	43	27	1.5	NA
242313		13	13	16	21	33	48	33	2	244313
242316		16	16	19	27	43	61	40	3.2	244316
242319		19	19	22	32	51	72	48	4.7	244319
242322		22	22	25	37	58	84	54	6.5	244322
242325		25	25	29	43	68	95	60	8.5	244325
242329		29	29	32	46	74	108	67	9.5	244329
242332		32	32	35	52	83	119	76	12	244332
242335		35	35	38	57	92	133	84	13	244335
242338		38	38	41	60	98	146	92	17	244338
242344		44	44	51	73	127	178	110	25	242344
242351		51	51	57	83	146	197	127	35	244351
242357		57	57	63	95	140	222	143	45	244357
242363		63	63	70	105	184	267	152	55	244363
242370		70	70	76	114	194	305	194	70	244370
242376		76	76	83	127	220	330	200	85	244376
242389		89	89	95	146	241	381	241	120	244389
2423102		102	102	108	165	279	432	235	150	2443102

SHACKLES



High-tensile DEE Shackles

- When requested and at no extra charge, Sinoforge-High-tensile shackles come with S-Lifting's standard test certificate.
- As a further means of traceability, the pins are painted yellow to indicate usage in the lifting industry in association with grade 80 lifting fittings, which are also painted yellow.
- High-tensile shackle bodies are two-thirds punched and the remaining third machined.
- S-Lifting High-tensile shackles come in screw pin dees, screw pin bows, safety dees and safety bow.

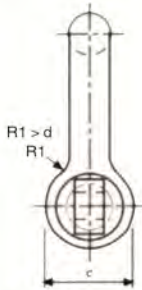

SKETCH 4-1(1)



PICTURE 4-1



PICTURE 4-2

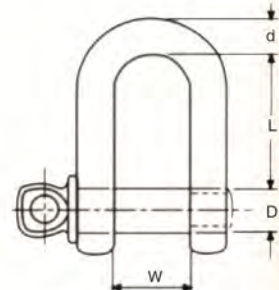

SKETCH 4-2(1)

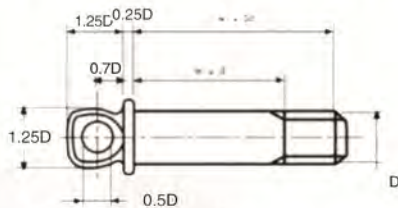
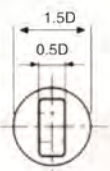

SKETCH 4-1(2)

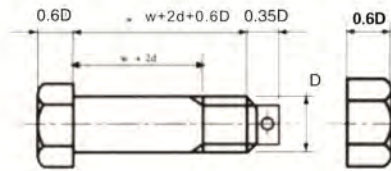

SKETCH 4-2(2)



Dee Screw Collar Pin Chain Shackle	Nominal Size	Dia. Body	Dia. Pin	Inside Width	Inside Length	Dia Boss	Work Load Limit	Dee Safety Chain Shackle
Item No	Dia mm	d mm	D mm	W mm	L mm	e mm	W.L.L Tonnes	Item No
241306	6	6	8	12	22	17	0.5	NA
241308	8	8	10	13	26	21	0.75	NA
241310	10	10	11	17	32	25	1	NA
241311	11	11	13	18	37	27	1.5	NA
241313	13	13	16	21	41	33	2	243313
241316	16	16	19	27	51	40	3.2	243316
241319	19	19	22	32	60	48	4.7	243319
241322	22	22	25	37	71	54	6.5	243322
241325	25	25	29	43	81	60	8.5	243325
241329	29	29	32	46	90	67	9.5	243329
241332	32	32	35	52	100	76	12	243332
241335	35	35	38	57	113	84	13	243335
241338	38	38	41	60	124	92	17	243338
241344	44	44	51	73	146	110	25	241344
241351	51	51	57	83	171	127	35	243351
241357	57	57	63	95	181	143	45	243357
241363	63	63	70	105	203	152	55	243363
241370	70	70	76	114	216	160	70	243370
241376	76	76	83	127	229	178	85	243376
241389	89	89	95	146	267	203	120	243389
2413102	102	102	108	165	318	235	150	2433102